

# Ikelos WERNER



**Atlantic Kayak Tours Says:** The Ikelos is a great paddle. It is Werner's first high angle sea kayaking paddle. A few years ago Werner came out with a foam core paddle. In 2003 Werner came out with the Kalliste, a low angle foam core paddle. Foam Core paddles are light and have lots of flotation. The blade floats to the surface making rolling easier. While this is a proven design we still want to know how it holds up over a few years of hard use. The Ikelos is a large high angle blade. Good for the 210 cm to 220 cm lengths. We will report more on the Ikelos once we get some miles paddled with it.

Werner offers the Ikelos with a straight or bent shaft in carbon. While the bent shaft costs slightly more than the straight shaft version, we strongly recommend the bent shaft. We find that most people prefer the bent shaft. It does take a few days to adjust to the feel of a bent shaft paddle, but once you adjust you won't want to go back to a straight shaft.

**Werner Says:** The Ikelos is an aggressive High Angle design for experienced paddlers who want a light weight paddle with both a powerful forward stroke and smooth linking strokes.

Our foam core blades offer a light buoyant stroke with a little spring at the exit of each stroke. The buoyancy and light swing weight is especially appreciated on longer paddle outings. The added buoyancy also greatly enhances bracing and rolling and is especially stable in aerated water. For added edge durability we mold a layer of Dynel™ around the edge and a double layer in the tip where paddles are prone to wear. Our whitewater models include an impact resistant layer of Kevlar. The Strong Dihedral combined with the smooth back of our Foam Core touring designs creates the right combination for both smooth forward strokes and smooth feathering strokes. The smooth back also allows water to flow uninterrupted, creating very little turbulence for an extremely quiet entry and exit.

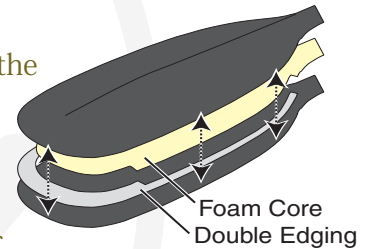

## Ikelos Specs

- Large High Angle blade with a powerful catch
- Foam core blade design is light and durable
- Extremely stable bracing and rolling
- Also Excellent for fitness paddling and racing
- Straight or Neutral Bent Shaft
- Standard or small diameter
- Adjustable Ferrule system
- Blade area 710 sq. cm.
- Paddle Lengths 205-230
- Blade Length 49 cm, Blade Width 20 cm
- Weight for size 220 cm
- All Carbon-Straight: 26 oz.
- All Carbon-Bent: 27 oz.
- Ultra-Light: 21 oz.

The Bent Shaft Option reduces stress on wrists and elbows.

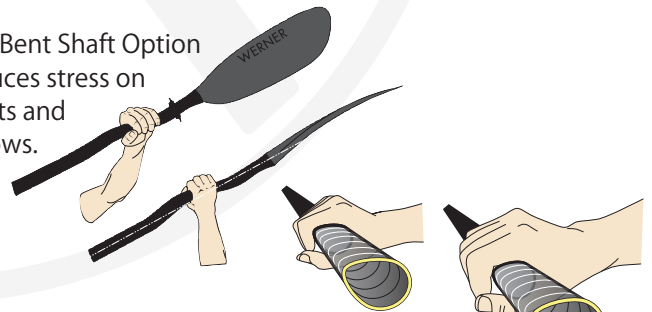

The size of the paddle shaft must match your hand size.

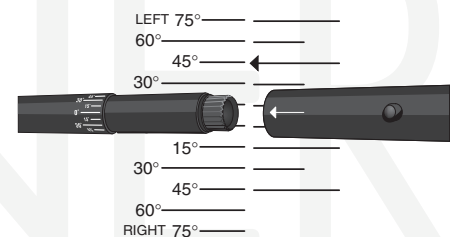

The Adjustable Ferrule System is standard on all Premium Paddles.

## 2006 Retail Prices

1 piece straight carbon:	\$360
2 piece straight carbon:	\$375
4 piece straight carbon:	\$435
1 or 2 piece bent carbon:	\$450
1 piece Ultralight Straight:	\$425